

US-35 E STANDPIPE ROAD,

JACKSON OHIO, FRANKLIN TOWNSHIP,
45640
TURN LANE LENGTHENING

"JAL-35-18.16 - 01"

VRS
↑

BASE @ ODOT CORS STA.
"PRS 51741367733"

1 CNPT, REBAR w/ "BG ENG
CONTROL" CAP SET
- 100' N E STANDPIPE RD
- 65' W E US35 / CTR MEDIAN

2 CNPT, REBAR w/ "BG ENG
CONTROL" CAP SET
- 600' N E STANDPIPE RD
- 60' W E US35 / CTR MEDIAN

500 BM1, BENCH TIE SET IN S/E SIDE
OF ~~B~~ NO #
- 122' W WESTERLY EP US35
- 14 S/E CORNER OF STORAGE BLDG
@ 1981 STANDPIPE RD
(SOUTH/EASTERLY MOST BUILDING)
* FROM S/E CORNER *

(Kw)
FE 10-6-2025

53/8

NOTE: USED + HELP OHIO COUNTY
COORDINATE SYSTEM,
ODOT LDP, JACKSON COUNTY,
NAD83(2011), NAD88, w/ GEOID 18.

CONTROL SKETCH
* NOT TO SCALE

54/8

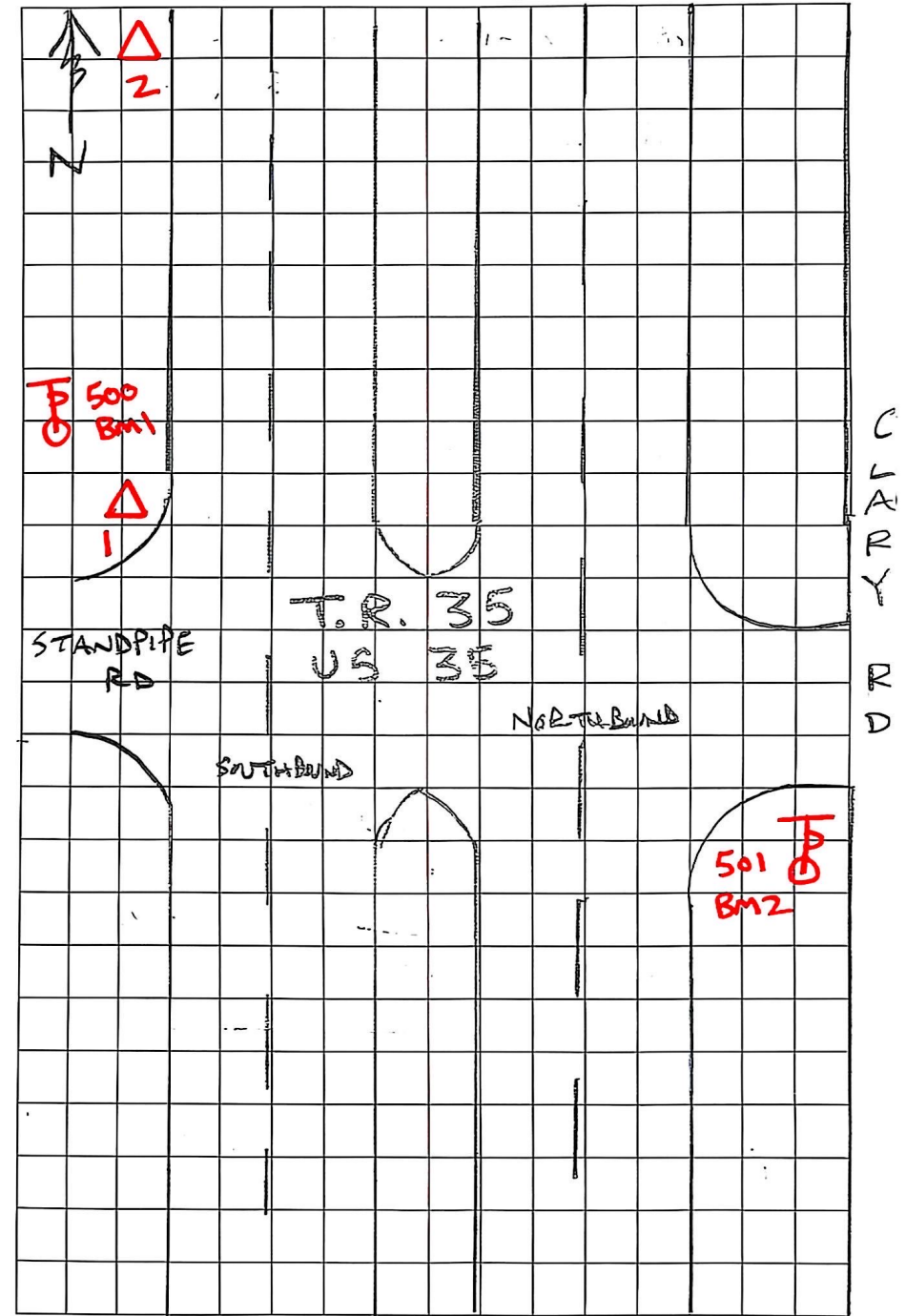

501	BM2	BENCH TIE 12" π UP ON SIDE OF π "BREC 080041"		
-	81'	S	E	STANDPIPE RD
-	24'	W	E	CLARY RD
<u>BENCH RUN</u>				
1				781.789'
	4.845'			786.634
501 (BM2)			5.79	780.844'
	5.58'			786.424'
TP			4.63	781.794'
	11.22			793.014'
500 (BM1)			1.67'	791.344'
	1.83			793.174'
TP			11.415'	781.759'
	4.145			785.904'
2			6.16'	779.744'
	5.945			785.689
TP			3.93	781.759'
	5.95'			787.709
1			5.91	781.799' ✓

1235	"DO NOT ENTER"
------	----------------

$$\frac{55}{8}$$

5202-8-01

CLEAR

[illegible]

27" \emptyset Elliptical RCP
(From CBS)

"STOP" $\frac{1}{2}$

CBS * (outflow @ 1321)

11

JACKSON COUNTRY CR 55

STANDPIPE RD

"EAST 35"

"OHIO BYWAY"

"WELSH BYWAY"

"DO NOT ENTER"

'SAME AS #1236'		
-----------------	--	--

CBS	*
-----	---

∇ @ 2 BS | 00000 HI: 5.40'
 (1451-1493)

1491 "STANDPIPE RD"

